

SEWAGE CONNECTION PLAN FOR 6+IV STORIED RESIDENTIAL BUILDING OF SRI HARI NARAYAN CHATTERJEE, SRI HARI KINKAR CHATTERJEE & SRI HARI BHUSHAN CHATTERJEE TO BE CONSTRUCTED AT L. R. PLOT NO. - 246 & 242, L.R. KHATIAN NO. - 4537, 5141, 5142 & 5143 UNDER MOUZA- ASANSOL, J.L. NO. - 35, P.S. - ASANSOL (SOUTH), DIST- PASCHIM BURDWAN IN WARD NO. - 18(O) & 86 (N), UNDER ASANSOL MUNICIPAL CORPORATION.

PRODUCED BY AN AUTODESK EDUCATIONAL PRODUCT

PRODUCED BY AN AUTODESK EDUCATIONAL PRODUCT

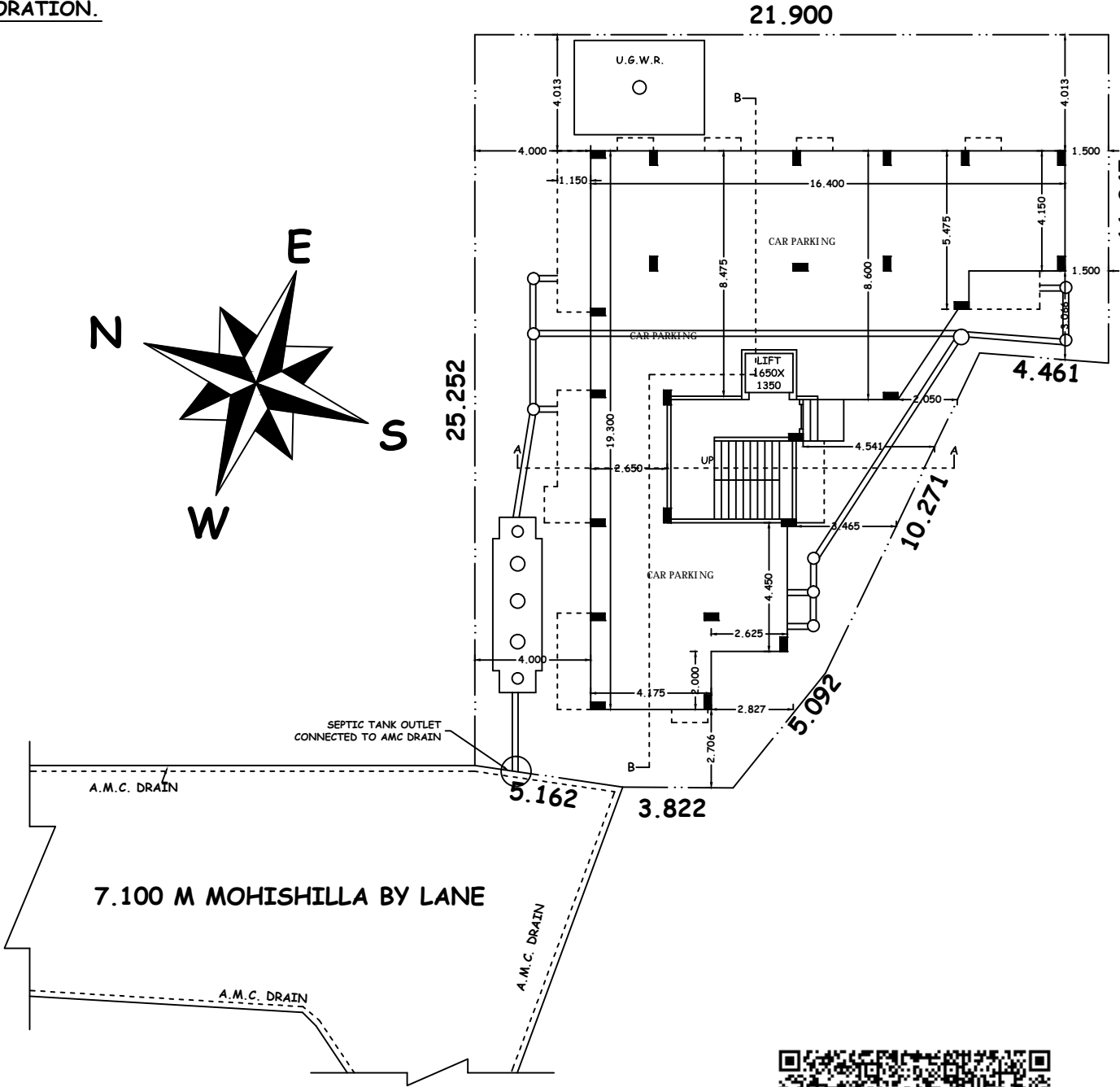

SEWAGE CONECTION PLAN
SCALE 1:1

